

# G830 2.0 HVLP Spray Gun Parts Diagram

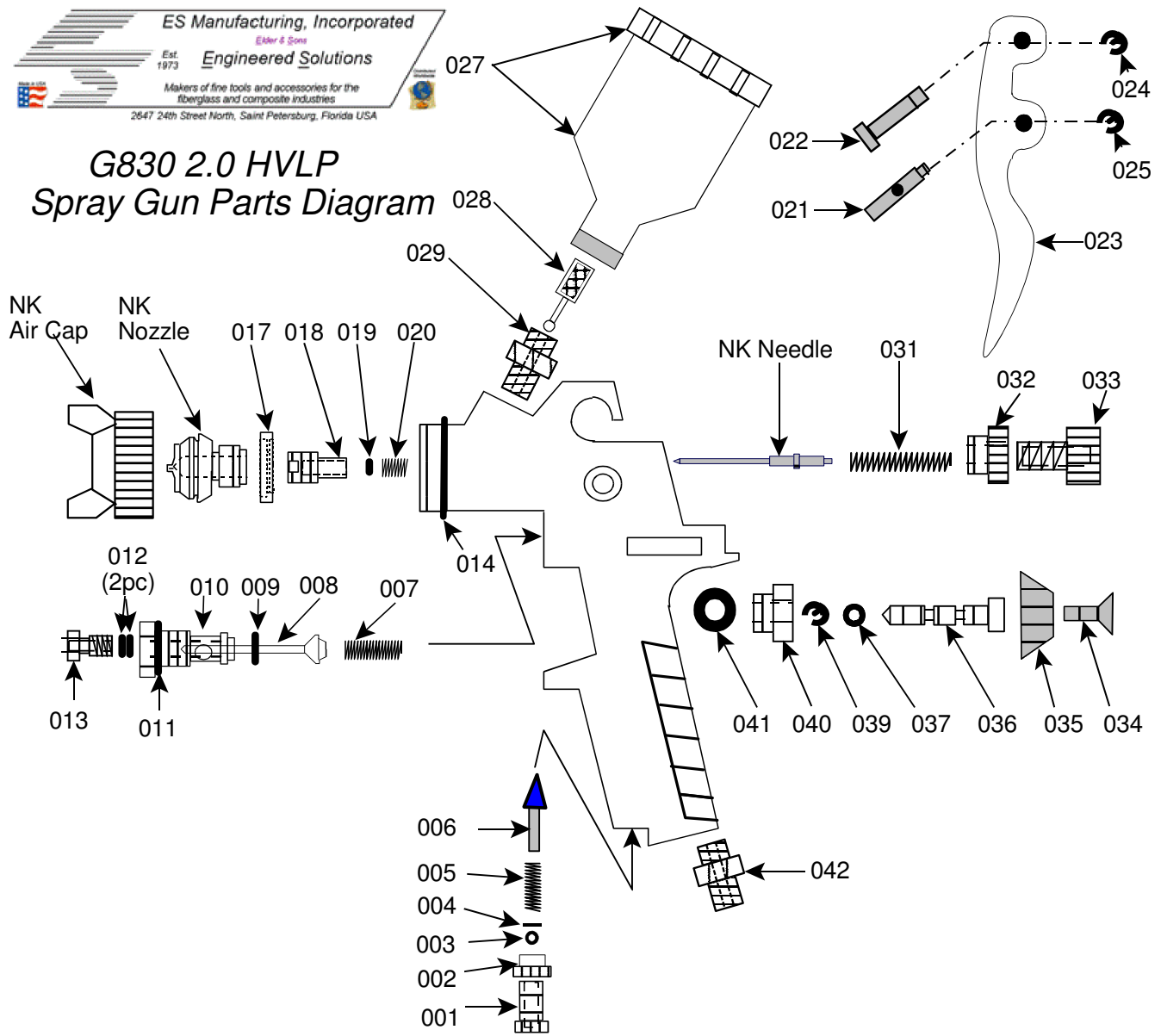

- G830001 Air Adjustment Knob
- G830002 Air Adjustment Body
- G830003 Air Adj. "O" Ring
- G830004 Air Adj. "E" Clip
- G830005 Air Adjustment Spring
- G830006 Air Adjustment Stem
- G830007 Trigger Valve Spring
- G830008 Trigger Valve Stem
- G830009 Trigger Body Seal
- G830010 Trigger Valve Body
- G830011 Trigger Head "O" Ring
- G830012 Trigger Stem Seal (2pc)
- G830013 Trigger Valve Knob
- G830014 Air Cap "O" Ring
- G830017 Nozzle Washer
- G830018 Brass Slotted Nut
- G830019 Slotted Nut Seal
- G830020 Internal Spring
- G830021 Lower Trigger Pin
- G830022 Upper Trigger Pin

- G830023 Plated Trigger
- G830024 Upper Trigger "E" Clip
- G830025 Lower Trigger "E" Clip
- G830027P Plastic 120cc Cup Assy.
- G830027A Alum. 200cc Cup Assy.
- G830028 Material Filter
- G830029 Fluid Inlet
- G830031 Needle Spring
- G830032 Knurled Material Nut
- G830033 Knurled Material Knob
- G830034 Pattern Adj. Lock Screw
- G830035 Pattern Adjustment Knob
- G830036 Pattern Adj. Screw
- G830037 Pattern Adj. "O" Ring
- G830039 Pattern Adj. "E" Clip
- G830040 Pattern Adj. Joint
- G830041 Pattern Joint "O" Ring
- G830042 Air Inlet Nipple

- Available Nozzle Kits:
- G830NK20 2.0mm Nozzle Kit
  - G830NK12 1.2mm Nozzle Kit
  - G830NK10 1.0mm Nozzle Kit
  - G830NK08 0.8mm Nozzle Kit