

ES Manufacturing, Incorporated

Est.
1973

Engineered Solutions

Made in USA



Manufacturers of fine tools and accessories
for the fiberglass and composite industries

Distributed
Worldwide



2647 24th Street North, Saint Petersburg, Florida USA

XB-200 Parts Diagram

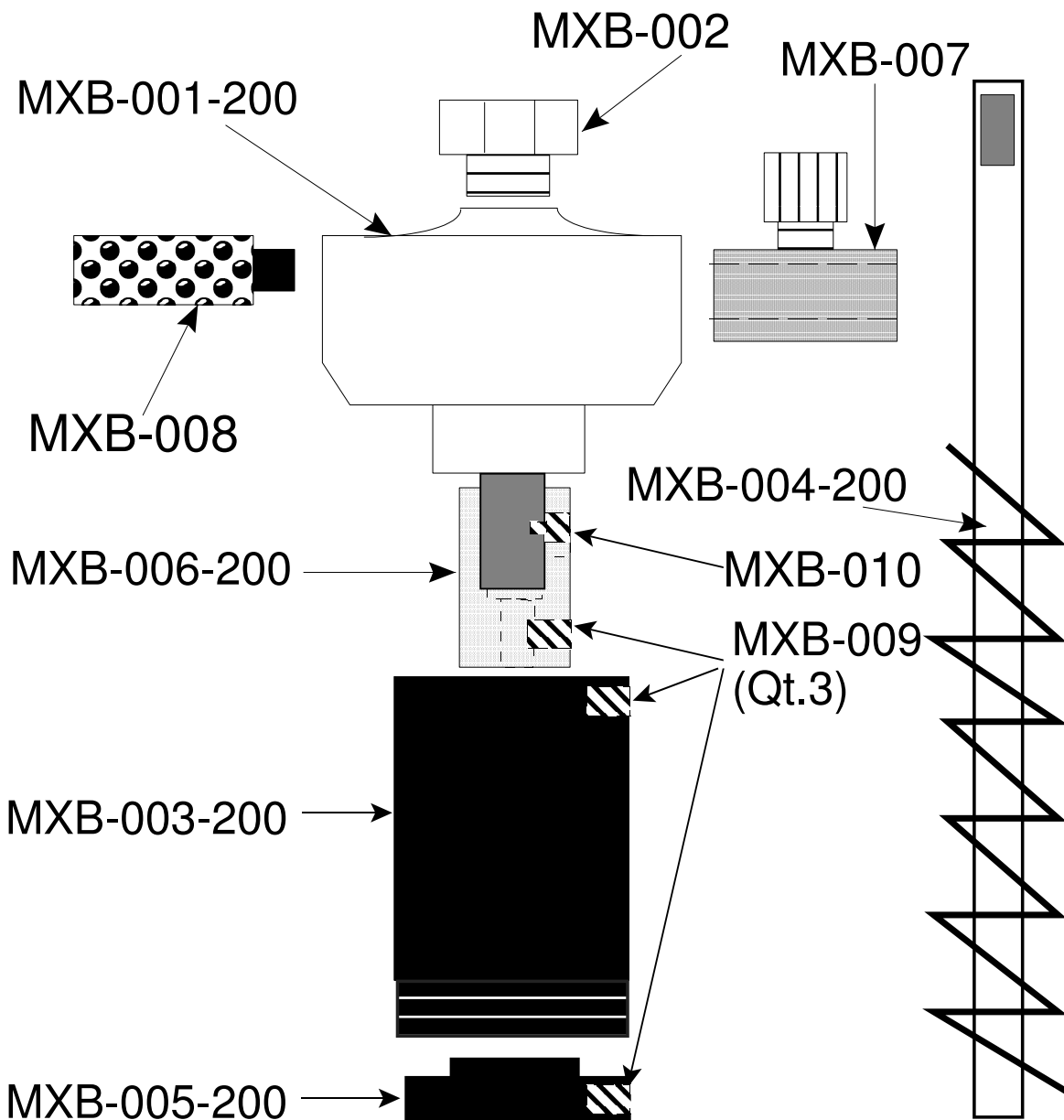

- | | |
|--------------------------------------|-------------|
| Steel Shaft Coupling | MXB-006-200 |
| 3/8" Graduated Needle Valve | MXB-007 |
| Metal Motor Muffer | MXB-008 |
| 1/4-20 x 1/4" Set Screw (3 Required) | MXB-009 |
| 1/4-20 x 3/8" Turned Set Screw | MXB-010 |
| 1.5HP Air Motor | MXB-003-200 |
| Motor Beating Cap | MXB-004-200 |
| Anodized Mixer Body | MXB-005-200 |
| 20mm SS Screw Type Shaft | MXB-006-200 |
| Delrin Resin Block Bushing | MXB-007 |

MXB-200 Parts List